

WEST SUSSEX COUNTY COUNCIL  
((CRAWLEY BOROUGH) (PARKING PLACES AND TRAFFIC REGULATION)  
(CONSOLIDATION) ORDER 2010)  
(TELFORD PLACE AMENDMENT) ORDER 2012

# CRAWLEY BOROUGH: LOCATION OF WAITING RESTRICTIONS

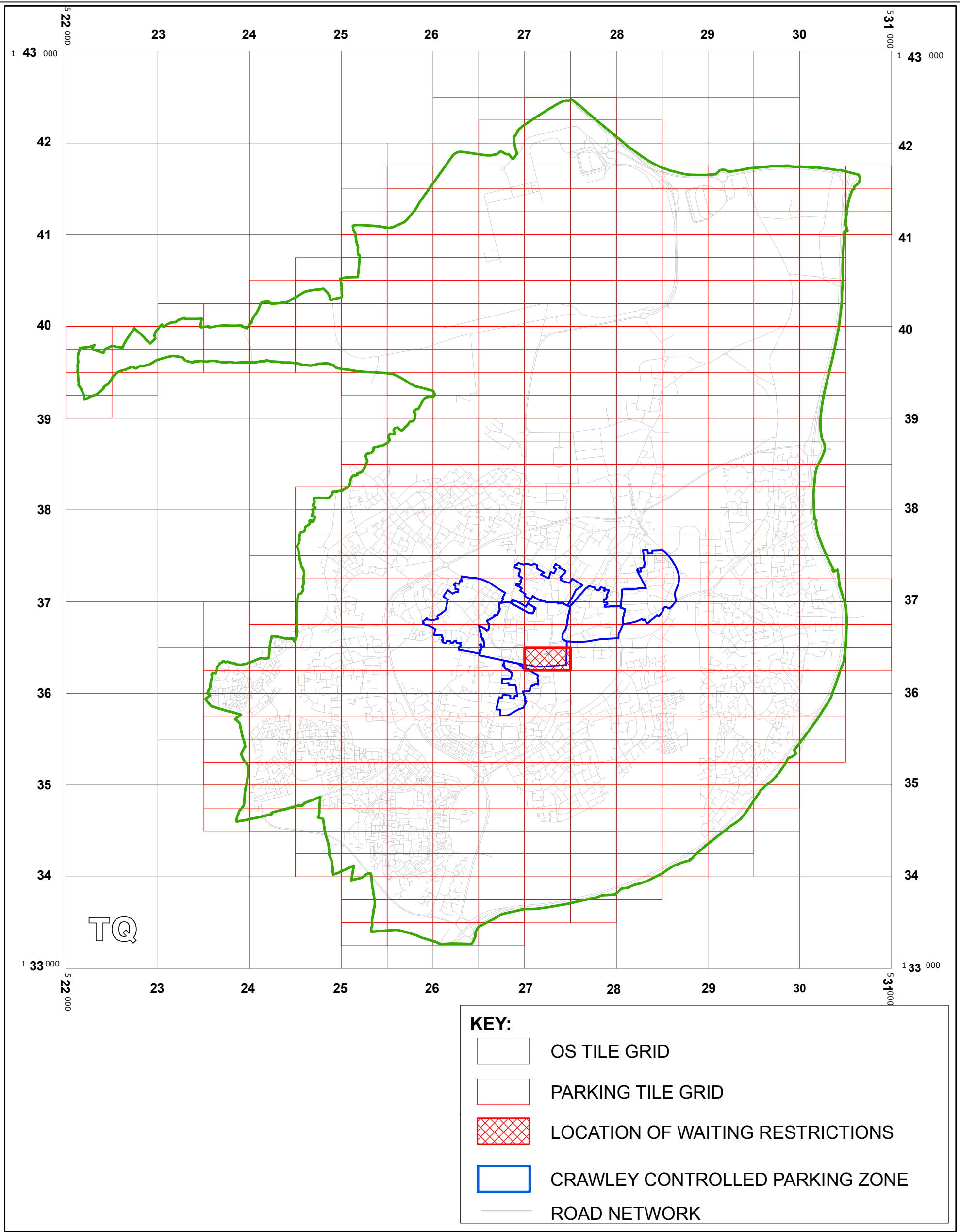

West Sussex County Council  
Communities & Infrastructure  
The Grange  
Tower Street  
Chichester  
West Sussex  
PO19 1RH

WEST SUSSEX COUNTY COUNCIL  
(CRAWLEY BOROUGH) (PARKING PLACES AND  
TRAFFIC REGULATION) (CONSOLIDATION)  
ORDER 2010) (TELFORD PLACE AMENDMENT)  
ORDER 2012

LOCATIONS OF WAITING RESTRICTIONS



Reproduced from or based upon 2010 Ordnance Survey mapping  
with permission of the Controller of HMSO (c) Crown Copyright reserved.  
Unauthorised reproduction infringes Crown copyright and may lead  
to prosecution or civil proceedings West Sussex County Council Licence No. 100023447

SCALE: 1:40,000  
DATE: 02/07/2012

Key for Waiting Restrictions

All areas over which the provision of the orders apply are defined by the shaded areas as shown on the following plans plus a contiguous area not indicated on the plans of verge and/or footway between the carriageway edge and the highway boundary. The plans in this schedule are based upon grid references of the Ordnance Survey National Grid defined by the OSGB 36 triangulation.

Prohibition of waiting

100



z\_circle

No waiting, loading and unloading at any time

101



check

No waiting at any time

Charged on-street parking (Cyan 0-255-255)

322

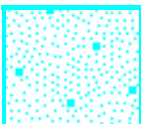

pat055

Pay and Display up to 3hrs 7.00am-6.00pm any day

Residents Parking (Green 0-255-0)

512

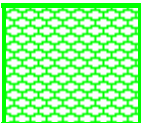

usgs503

Residents’ and Visitors’ permit holders only  
9.00am-5.00pm Mon-Sat except bank holidays

Specified Vehicles

854

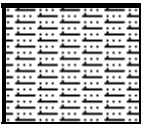

usgs617

No waiting at any time except taxis 12.00am-3.00am



Boundary of Controlled Parking Zone

**WEST SUSSEX COUNTY COUNCIL**  
**((CRAWLEY BOROUGH) (PARKING PLACES AND TRAFFIC REGULATION)**  
**(CONSOLIDATION) ORDER 2010)**  
**(TELFORD PLACE AMENDMENT) ORDER 2012**

West Sussex County Council in exercise of their powers under Sections 1 (1) 2 (1) and (2), 4 (2), 45, 46, 49 and 53 and Part IV of Schedule 9 of the Road Traffic Regulation Act 1984 "the Act" as amended and of all other enabling powers and after consultation with the chief officer of police in accordance with Part III of Schedule 9 to the Act hereby make the following Order:

1. This Order shall come into operation on the 2<sup>nd</sup> day of July 2012 and may be cited as "West Sussex County Council ((Crawley Borough) (Parking Places and Traffic Regulation) (Consolidation) Order 2010) (Telford Place Amendment) Order 2012."
2. The "West Sussex County Council (Crawley Borough) (Parking Places and Traffic Regulation) (Consolidation) Order 2010" is hereby amended by
  - (i) the deletion from it of the plan specified in the First Schedule to this Order; and
  - (ii) the substitution of the plan attached in the Second Schedule to this Order; and
  - (iii) the addition to Item 3 of the Second Schedule of the Order, of the Charges & Tariffs in the Third Schedule to this Order.

**FIRST SCHEDULE**  
**Plan to be deleted**

TQ2736SWN (Sheet Issue No. 1)

**SECOND SCHEDULE**  
**Plan to be inserted**  
**(as attached)**

TQ2736SWN (Sheet Issue No. 2)

**THIRD SCHEDULE**  
**Charges & Tarriffs**

**Telford Place**

<b>Time</b>	<b>Tarriff</b>
Upto 30 minutes	£0.70
Upto 1 hour	£1.40
Upto 1 hour 30 minutes	£2.00
Upto 3 hours	£3.00

THE COMMON SEAL of WEST SUSSEX  
 COUNTY COUNCIL was hereto affixed

the 26<sup>TH</sup> day of JUNE 2012  
 in the presence of:

*m dessler*  
 Authorised Signatory

)  
)  
)  
)  
) (L.S)  
)  
)  
)  
)

I HEREBY CERTIFY THIS TO  
 BE A TRUE COPY OF THE  
 ORIGINAL DOCUMENT

*Tony Kenward*  
 .....  
 Authorised Officer  
 WEST SUSSEX COUNTY COUNCIL

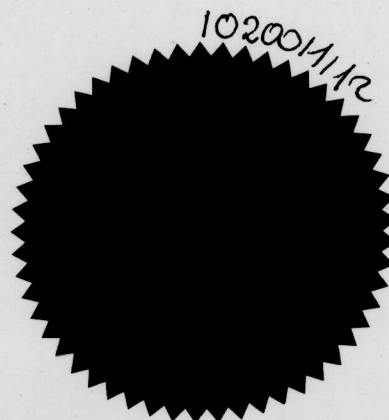



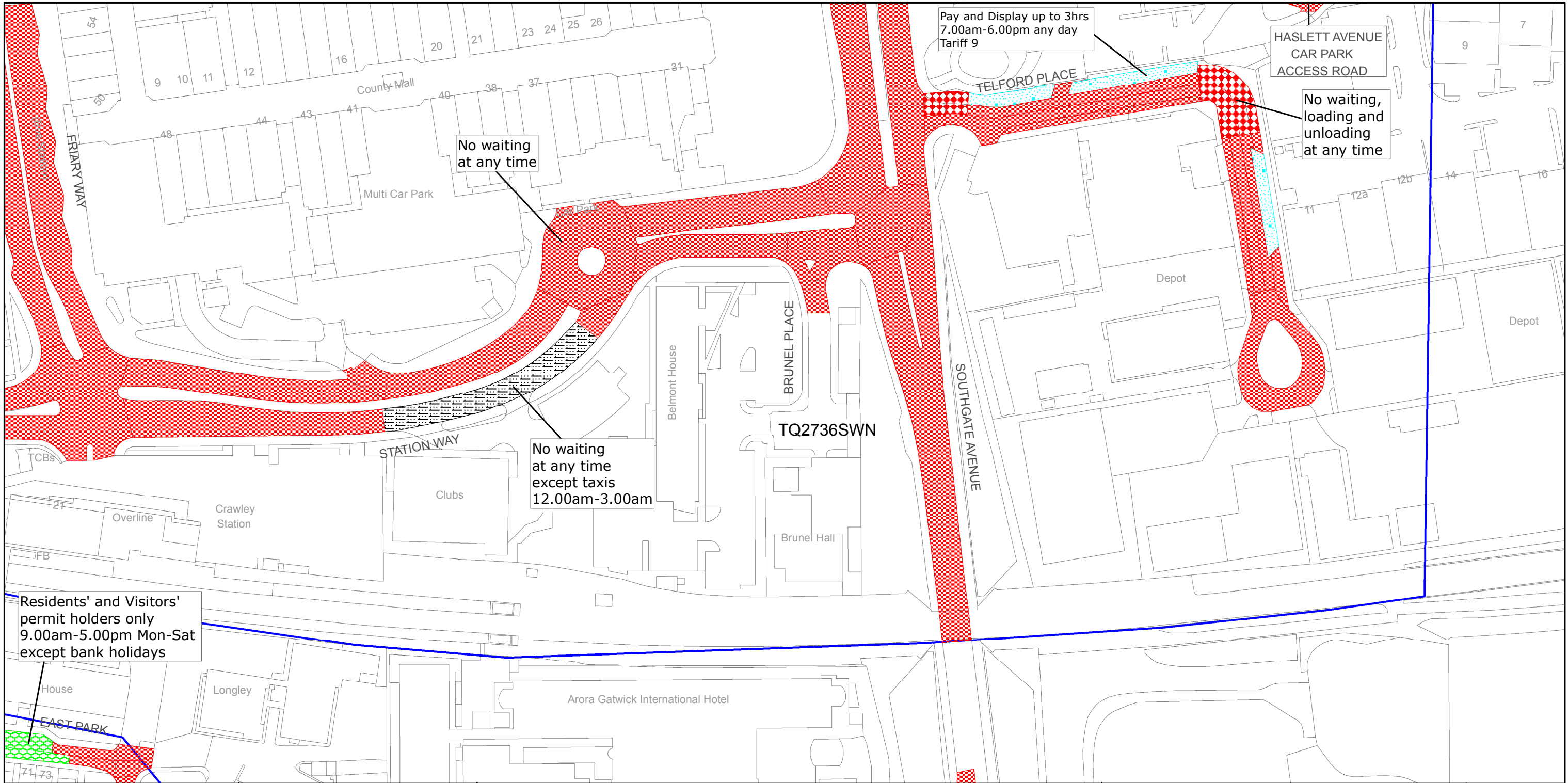

West Sussex County Council  
Communities & Infrastructure  
The Grange  
Tower Street  
Chichester  
West Sussex  
PO19 1RH

CRAWLEY BOROUGH: FURNACE GREEN, NORTHGATE,  
SOUTHGATE AND  
THREE BRIDGES WARDS

WAITING RESTRICTIONS

Reproduced from or based upon 2010 Ordnance Survey mapping with permission of the Controller of HMSO (c) Crown Copyright reserved.  
Unauthorised reproduction infringes Crown copyright and may lead to prosecution or civil proceedings West Sussex County Council Licence No. 100023447

TILE REF NO:  
TQ2736SWN

SHEET ISSUE NO 2

SHEET ACTIVE FROM - 02/07/2012



SCALE:  
1:1250  
at A3 size